

ALLEGATO ALL'ORDINANZA N° 84/2021 DEL 02/09/2021

Area di intervento 

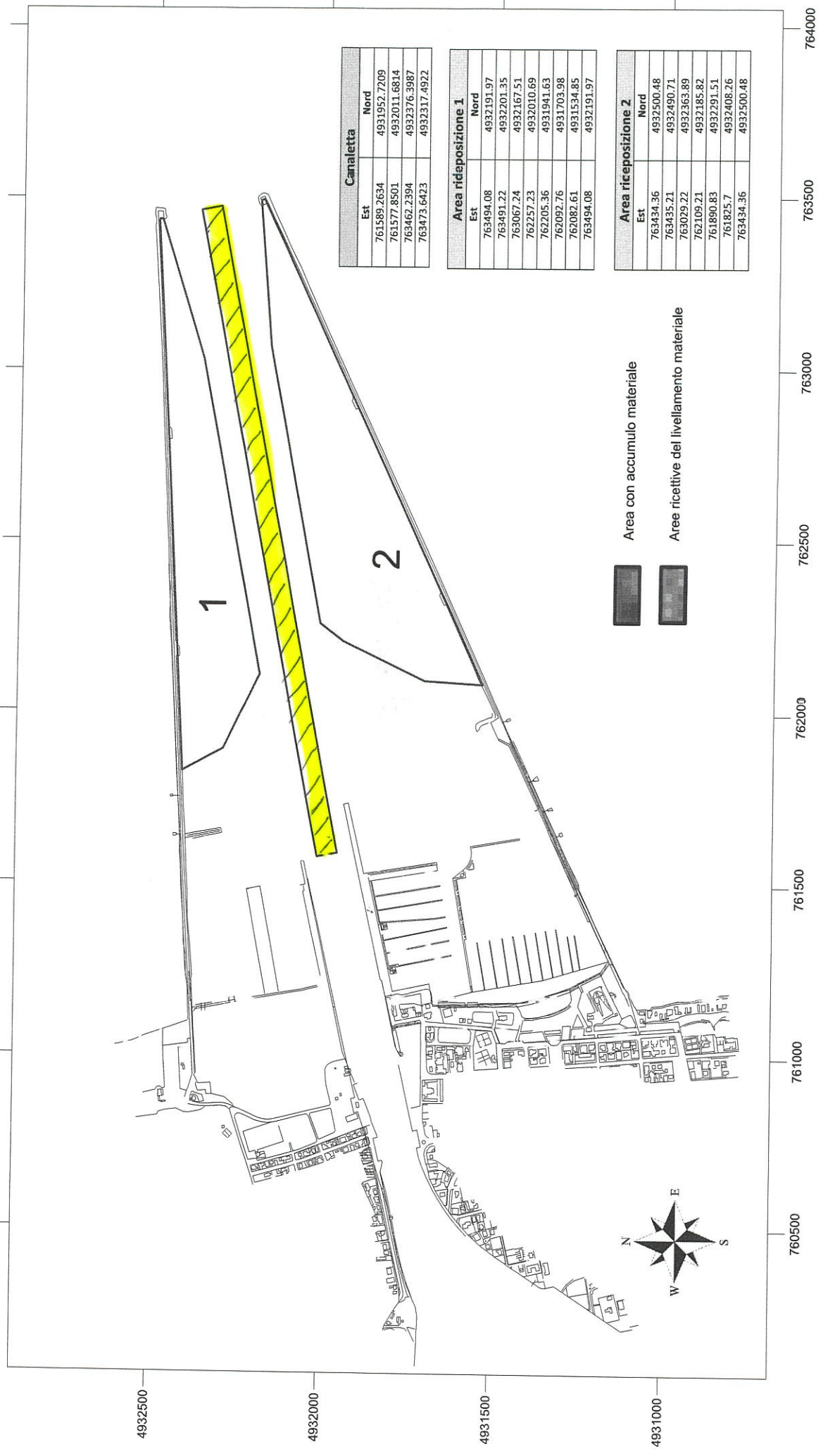

Canaletta	
Est	Nord
761589.2634	4931952.7209
761577.8501	4932011.6814
763462.2394	4932376.3987
763473.6423	4932317.4922

Area rideposizione 1	
Est	Nord
763494.08	4932191.97
763491.22	4932201.35
763067.24	4932167.51
762257.23	4932010.69
762205.36	4931941.63
762092.76	4931703.98
762082.61	4931534.85
763494.08	4932191.97

Area riceposizione 2	
Est	Nord
763434.36	4932500.48
763435.21	4932490.71
763029.22	4932363.89
762109.21	4932185.82
761890.83	4932291.51
761825.7	4932408.26
763434.36	4932500.48